

LEGEND

- SCHEME BOUNDARY
- GREEN BELT/ OPEN SPACES
- TO BE PLANNED LATER
- RELEASED LAND
- RE-PLANNED POCKETS
- LAND UNDER LITIGATION

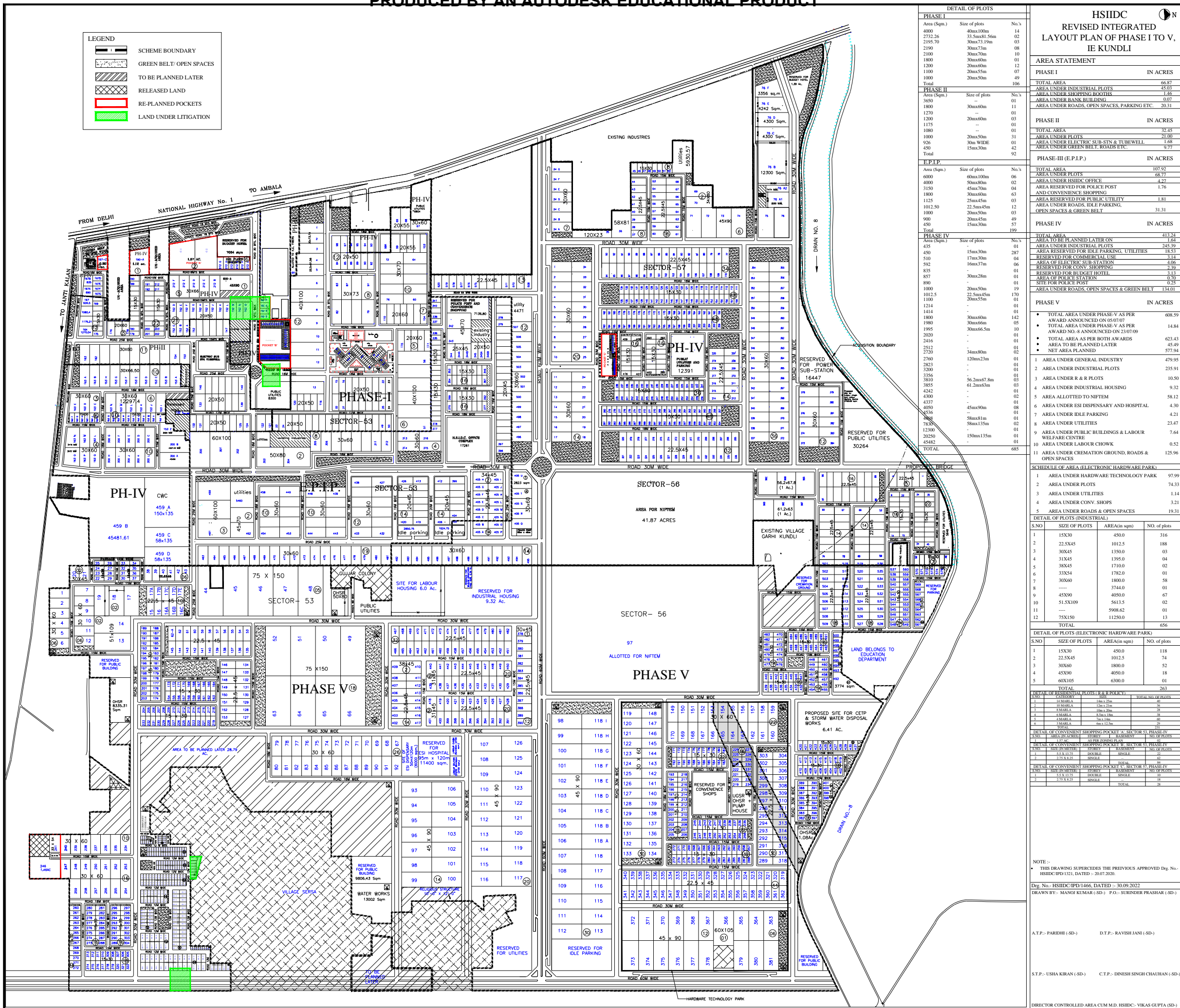

DETAIL OF PLOTS

PHASE I	Area (Sqm.)	Size of plots	No.'s
4000	40mx100m	14	
2732.26	33.5mx51.5m	02	
2195.70	30mx73.19m	03	
2190	30mx73m	08	
2100	30mx70m	10	
1800	30mx60m	01	
1200	20mx60m	12	
1100	20mx55m	07	
1000	20mx50m	49	
Total		106	

PHASE II	Area (Sqm.)	Size of plots	No.'s
3650	-	01	
1800	30mx60m	11	
1270	30mx70m	01	
1200	20mx60m	03	
1175	-	01	
1080	-	01	
1000	20mx50m	31	
926	30m WIDE	01	
450	15mx30m	42	
Total		92	

E.P.I.P.	Area (Sqm.)	Size of plots	No.'s
6000	60mx100m	06	
4000	50mx80m	02	
3150	45mx70m	04	
1800	30mx60m	63	
1125	25mx45m	03	
1012.50	22.5mx45m	12	
1000	20mx45m	03	
900	20mx45m	49	
450	15mx30m	57	
Total		199	

PHASE IV	Area (Sqm.)	Size of plots	No.'s
435	15mx30m	01	
450	15mx30m	287	
510	17mx30m	04	
592	16mx37m	06	
835	30mx50m	01	
857	30mx28m	01	
890	-	01	
1000	20mx50m	19	
1012.5	22.5mx45m	170	
1100	20mx55m	01	
1214	-	01	
1414	-	01	
1800	30mx60m	142	
1980	30mx66m	05	
1995	30mx66.5m	10	
2020	-	01	
2416	-	01	
2512	-	01	
2720	34mx80m	01	
2760	120mx23m	01	
2823	-	01	
3200	-	01	
3356	-	01	
3810	56.2mx67.8m	03	
3855	61.2mx63m	03	
4242	-	02	
4300	-	01	
4377	-	01	
4050	45mx90m	08	
536	-	01	
588x81m	-	01	
78x9	58mx135m	02	
12300	-	01	
20250	-	01	
45482	-	62	
TOTAL		685	

HSIIDC REVISED INTEGRATED LAYOUT PLAN OF PHASE I TO V, IE KUNDLI

AREA STATEMENT

PHASE I	IN ACRES
TOTAL AREA	66.87
AREA UNDER INDUSTRIAL PLOTS	45.03
AREA UNDER SHOPPING BROTHS	1.46
AREA UNDER BANK BUILDING	0.07
AREA UNDER ROADS, OPEN SPACES, PARKING ETC.	20.31

PHASE II	IN ACRES
TOTAL AREA	32.45
AREA UNDER PLOTS	31.00
AREA UNDER ELECTRIC SUB-STN & TUBEWELL	1.68
AREA UNDER GREEN BELT, ROADS ETC.	9.77

PHASE-III (E.P.I.P.)	IN ACRES
TOTAL AREA	107.92
AREA UNDER PLOTS	68.77
AREA UNDER HSIIDC OFFICE	4.27
AREA RESERVED FOR POLICE POST	1.76
AND CONVENIENCE SHOPPING	45.49
AREA RESERVED FOR PUBLIC UTILITY	1.81
AREA UNDER ROADS, IDLE PARKING, OPEN SPACES & GREEN BELT	31.31

PHASE IV	IN ACRES
TOTAL AREA	413.24
AREA TO BE PLANNED LATER ON	1.64
AREA UNDER INDUSTRIAL PLOTS	245.20
AREA RESERVED FOR IDLE PARKING, UTILITIES	18.53
RESERVED FOR COMMERCIAL USE	3.14
AREA OF ELECTRIC SUB-STATION	4.06
RESERVED FOR CONV. SHOPPING	8.29
RESERVED FOR BUDGET HOTEL	3.13
AREA OF POLICE STATION	0.20
SITE FOR POLICE POST	0.25
AREA UNDER ROADS, OPEN SPACES & GREEN BELT	134.01

PHASE V	IN ACRES
TOTAL AREA UNDER PHASE-V AS PER AWARD ANNOUNCED ON 05/07/07	608.59
TOTAL AREA UNDER PHASE-V AS PER AWARD NO.-8 ANNOUNCED ON 23/07/09	14.84
TOTAL AREA AS PER BOTH AWARDS	623.43
AREA TO BE PLANNED LATER	45.49
NET AREA PLANNED	577.94

SCHEDULE OF AREA (ELECTRONIC HARDWARE PARK)

S.NO.	AREA UNDER GENERAL INDUSTRY	AREA UNDER INDUSTRIAL PLOTS	AREA UNDER R & R PLOTS	AREA UNDER INDUSTRIAL HOUSING	AREA ALLOTTED TO NIFTM	AREA UNDER ESI DISPENSARY AND HOSPITAL	AREA UNDER IDLE PARKING	AREA UNDER UTILITIES	AREA UNDER PUBLIC BUILDINGS & LABOUR WELFARE CENTRE	AREA UNDER LABOUR CHOWK	AREA UNDER CREMATION GROUND, ROADS & OPEN SPACES
1	479.95	255.91	10.50	9.32	58.12	4.30	4.21	23.47	7.64	0.52	125.96
2	97.99	74.33	1.14	3.21	19.31						
3											
4											
5											
6											
7											
8											
9											
10											
11											
12											
TOTAL											656

DETAIL OF PLOTS (INDUSTRIAL)

S.NO.	SIZE OF PLOTS	AREA (in sqm)	NO. of plots
1	15X30	450.0	316
2	22.5X45	1012.5	188
3	30X45	1350.0	03
4	31X45	1395.0	04
5	38X45	1710.0	02
6	33X54	1782.0	01
7	30X60	1800.0	58
8	3744.0	01
9	45X90	4050.0	67
10	51.5X109	5613.5	02
11	5906.42	01
12	75X150	11250.0	13
TOTAL			656

DETAIL OF PLOTS (ELECTRONIC HARDWARE PARK)

S.NO.	SIZE OF PLOTS	AREA (in sqm)	NO. of plots
1	15X30	450.0	118
2	22.5X45	1012.5	74
3	30X60	1800.0	52
4	45X90	4050.0	18
5	60X105	6300.0	01
TOTAL			263

DETAIL OF INDUSTRIAL PLOTS (R & R PLOTS)

S.NO.	AREA (in sqm)	NO. OF PLOTS
1	1500.0	01
2	3000.0	01
3	4500.0	01
4	6000.0	01
5	7500.0	01
TOTAL		05

DETAIL OF CONVENIENCE SHOPPING POCKET 'A' (FOR S1, PHASE-IV)

S.NO.	AREA (in sqm)	NO. OF PLOTS
1	1500.0	01
2	3000.0	01
3	4500.0	01
4	6000.0	01
5	7500.0	01
TOTAL		05

DETAIL OF CONVENIENCE SHOPPING POCKET 'B' (FOR S2, PHASE-IV)

S.NO.	AREA (in sqm)	NO. OF PLOTS
1	1500.0	01
2	3000.0	01
3	4500.0	01
4	6000.0	01
5	7500.0	01
TOTAL		05

DETAIL OF CONVENIENCE SHOPPING POCKET 'C' (FOR S3, PHASE-IV)

S.NO.	AREA (in sqm)	NO. OF PLOTS
1	1500.0	01
2	3000.0	01
3	4500.0	01
4	6000.0	01
5	7500.0	01
TOTAL		05

NOTE:-
 * THIS DRAWING SUPERCEDES THE PREVIOUS APPROVED Dg. No. HSIIDC/EPD/131, DATED - 30/07/2020.
 Dg. No. - HSIIDC/EPD/1466, DATED - 30/09/2022
 DRAWN BY:- MANU KUMAR (SD) P.O.:- SURINDER PRASHAR (SD)

A.T.P.:- PARISHI (SD) D.T.P.:- RAVISH JANI (SD)
 S.T.P.:- USHA KHAN (SD) C.T.P.:- DINESH SINGH CHAUHAN (SD)
 DIRECTOR CONTROLLED AREA (CUM M.D.) HSIIDC:- VIKAS GUPTA (SD)